

Lote 4.4.1A.12				
VERTICE	LADO	DIST.	M	P
40	40 - 41	22.48	1076.33	-284986.20
41	41 - 3	40.46	1064.90	-285005.56
3	3 - 4	14.97	1102.36	-285020.87
4	4 - 40	37.31	1107.41	-285006.86

Lote	Áreas (m <sup>2</sup> )			
	lote	construção	implantação	impermeb.
4.4.1A/12	714	245	200	320

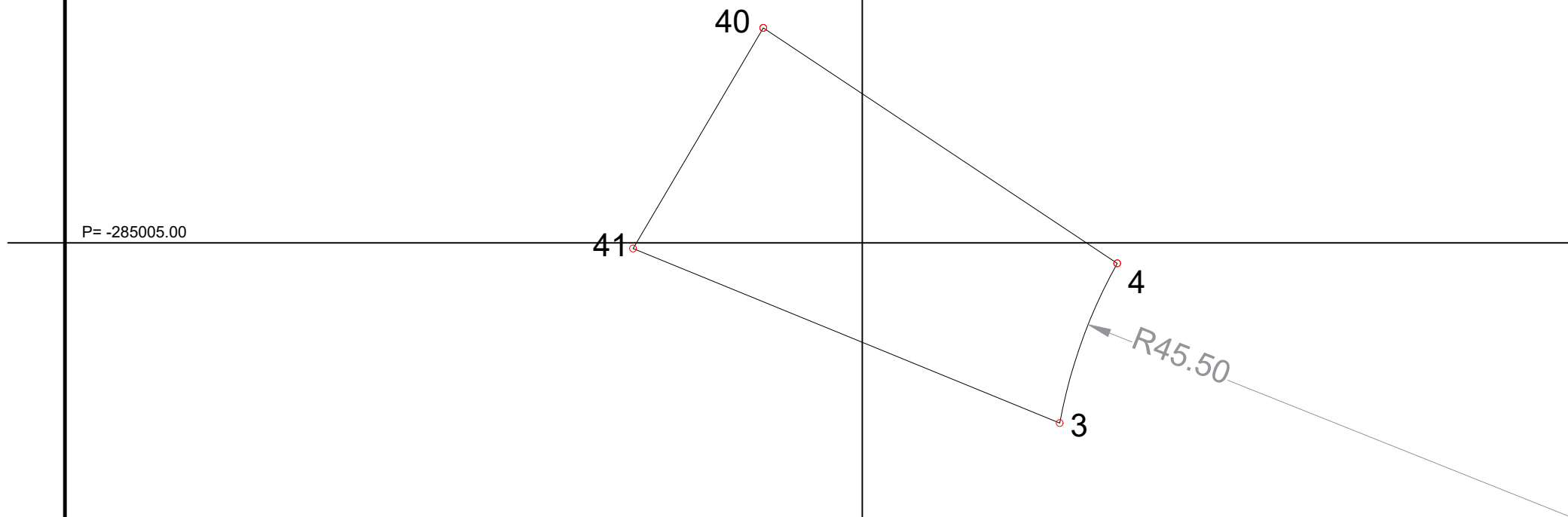

Escala = 1:500

# Vilamoura

## ALGARVE

LUSOTUR - Empreendimentos Imobiliários e Turísticos, S.A.

### PLANTA TOPOGRÁFICA

SETOR 4 ZONA 4  
 SUBZONA 1A LOTE 12

AREA 714 m<sup>2</sup>

### ORTOFOTOMAPA



ESCALA=1:10.000

### PLANTA DE LOCALIZAÇÃO

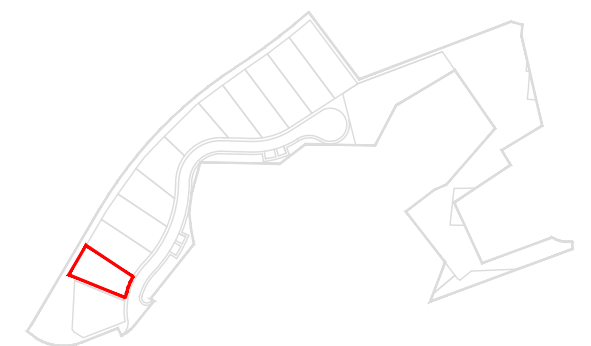

Escala = 1:5000

Lote 4.4.1A/13				
VERTICE	LADO	DIST.	M	P
4	4 - 40	37.31	1107.41	-285006.86
5	5 - 4	11.73	1114.38	-284997.47
6	6 - 5	8.39	1119.87	-284991.12
39	39 - 6	40.05	1086.51	-284968.95
40	40 - 39	20.03	1076.33	-284986.20

Lote	Áreas (m <sup>2</sup> )			
	lote	construção	implantação	impermeb.
4.4.1A/13	768	265	210	340

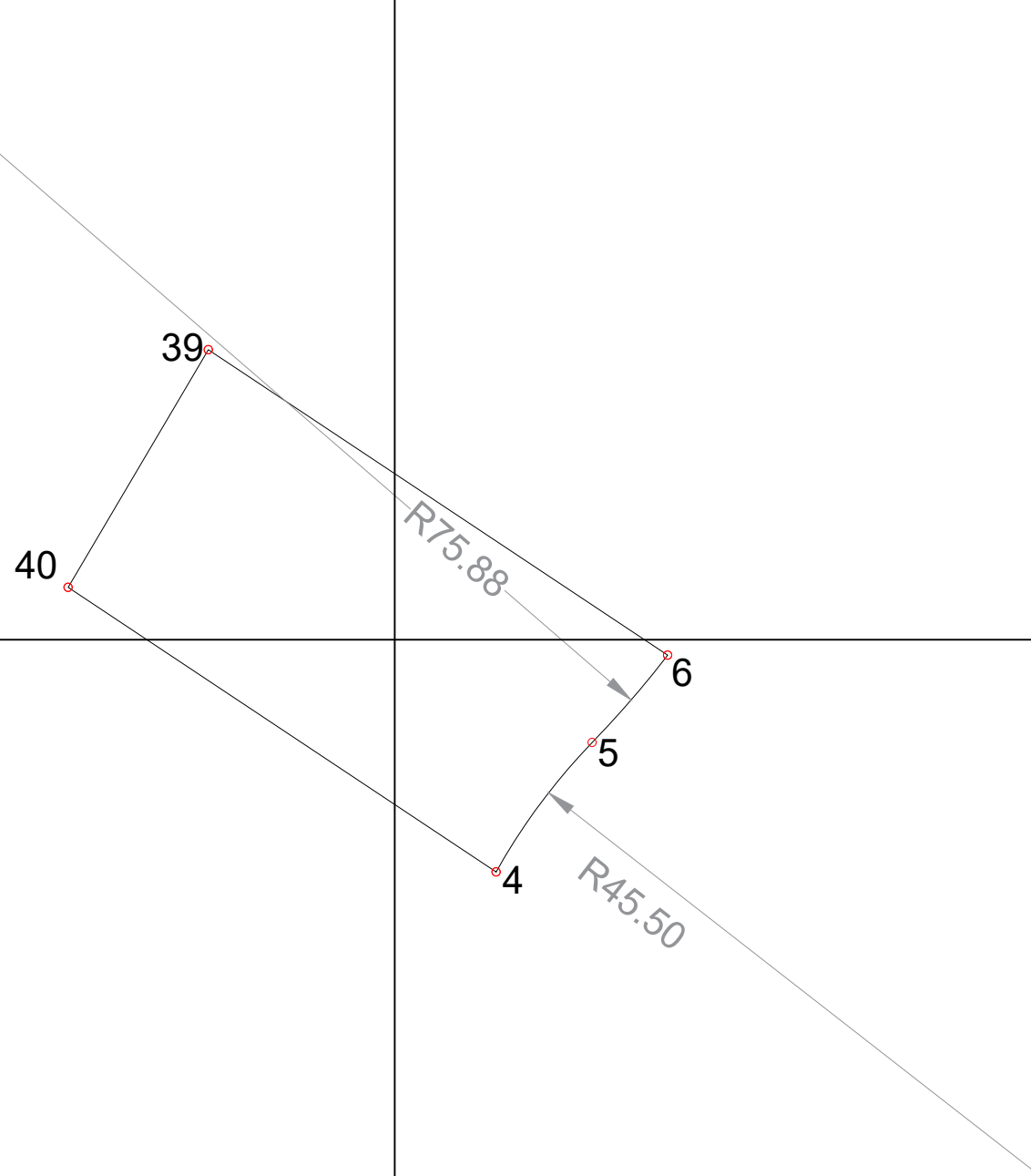

M= 1100

Escala = 1:500

# Vilamoura

## ALGARVE

LUSOTUR - Empreendimentos Imobiliários e Turísticos, S.A.

### PLANTA TOPOGRÁFICA

SETOR 4 ZONA 4  
 SUBZONA 1A LOTE 13  
 AREA 768 m<sup>2</sup>

ORTOFOTOMAPA



ESCALA=1:10.000

PLANTA DE LOCALIZAÇÃO

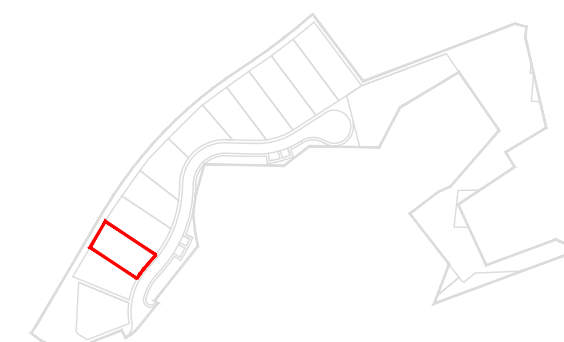

Escala = 1:5000

Lote 4.4.1A/14				
VERTICE	LADO	DIST.	M	P
37	37 - 7	39.04	1097.40	-284952.17
7	7 - 6	20.10	1129.91	-284973.78
6	6 - 39	40.05	1119.87	-284991.12
39	39 - 38	5.12	1086.51	-284968.95
38	38 - 37	14.89	1089.11	-284964.54

Lote	Áreas (m²)			
	lote	construção	implantação	impermeb.
4.4.1A/14	802	265	210	340

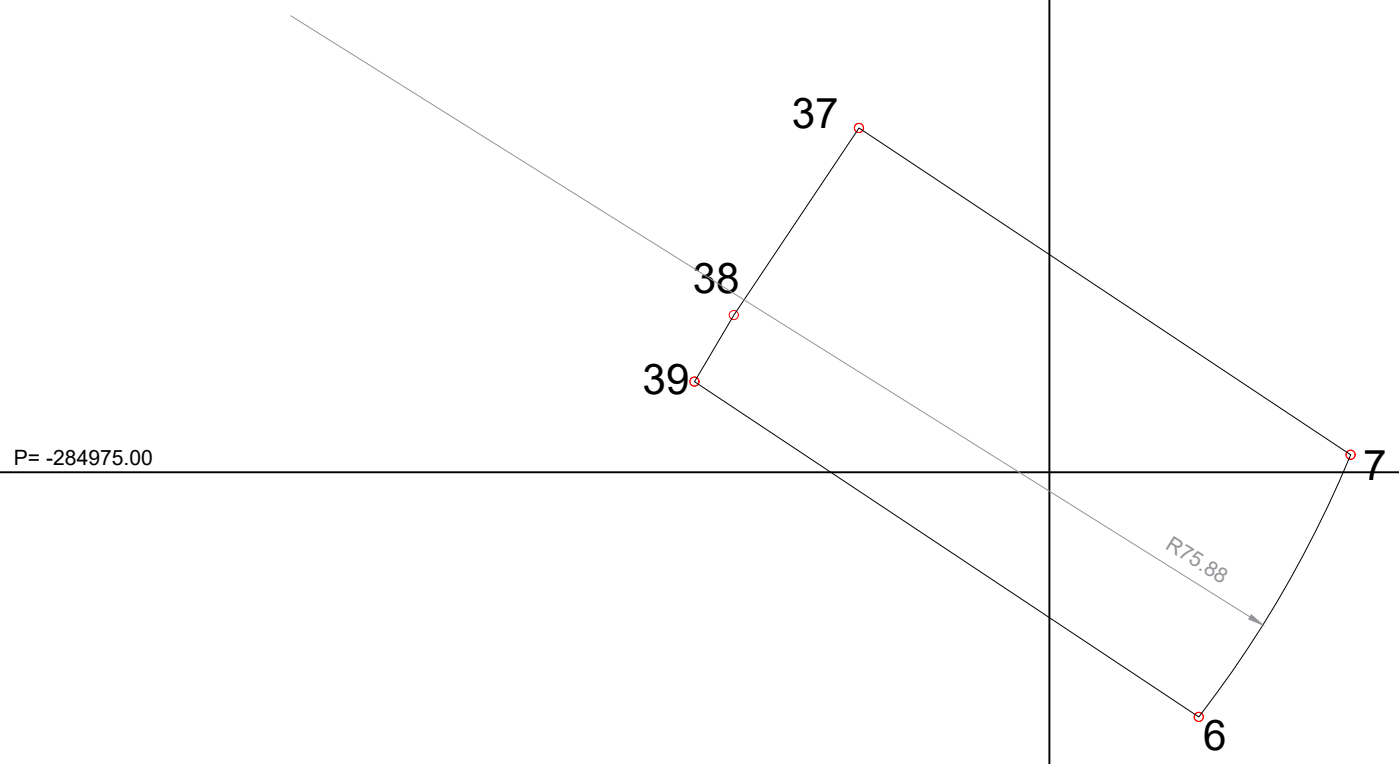

P= -284975.00

M= -1110

Escala = 1:500

# Vilamoura

## ALGARVE

LUSOTUR - Empreendimentos Imobiliários e Turísticos, S.A.

### PLANTA TOPOGRÁFICA

SETOR 4 ZONA 4  
 SUBZONA 1A LOTE 14  
 AREA 802 m2

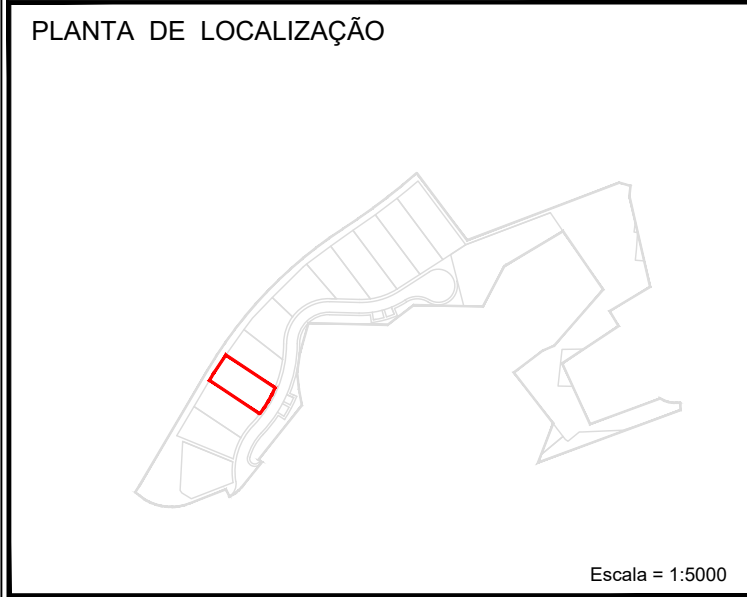
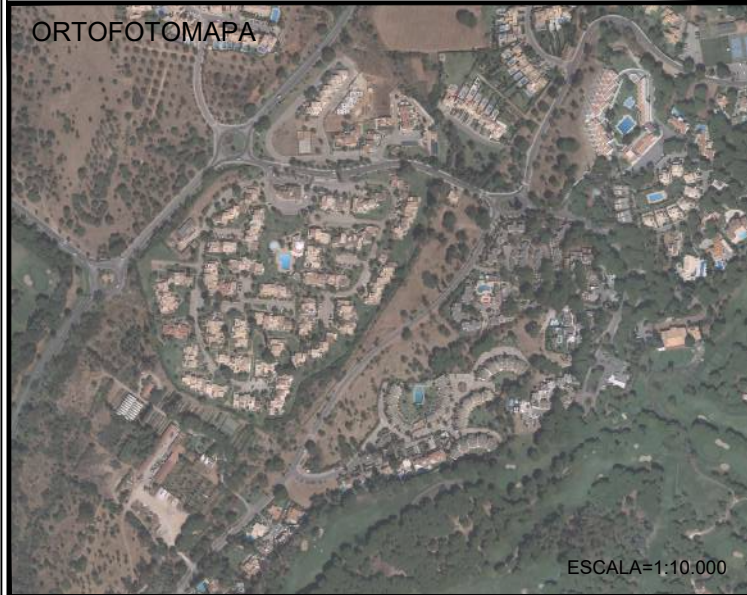

Lote 4.4.1A/15				
VERTICE	LADO	DIST.	M	P
36	36 - 8	32.36	1109.41	-284935.38
8	8 - 7	19.27	1134.96	-284955.24
7	7 - 37	39.04	1129.91	-284973.78
37	37 - 36	20.65	1097.40	-284952.17

Lote	Áreas (m²)			
	lote	construção	implantação	impermeb.
4.4.1A/15	698	245	200	320

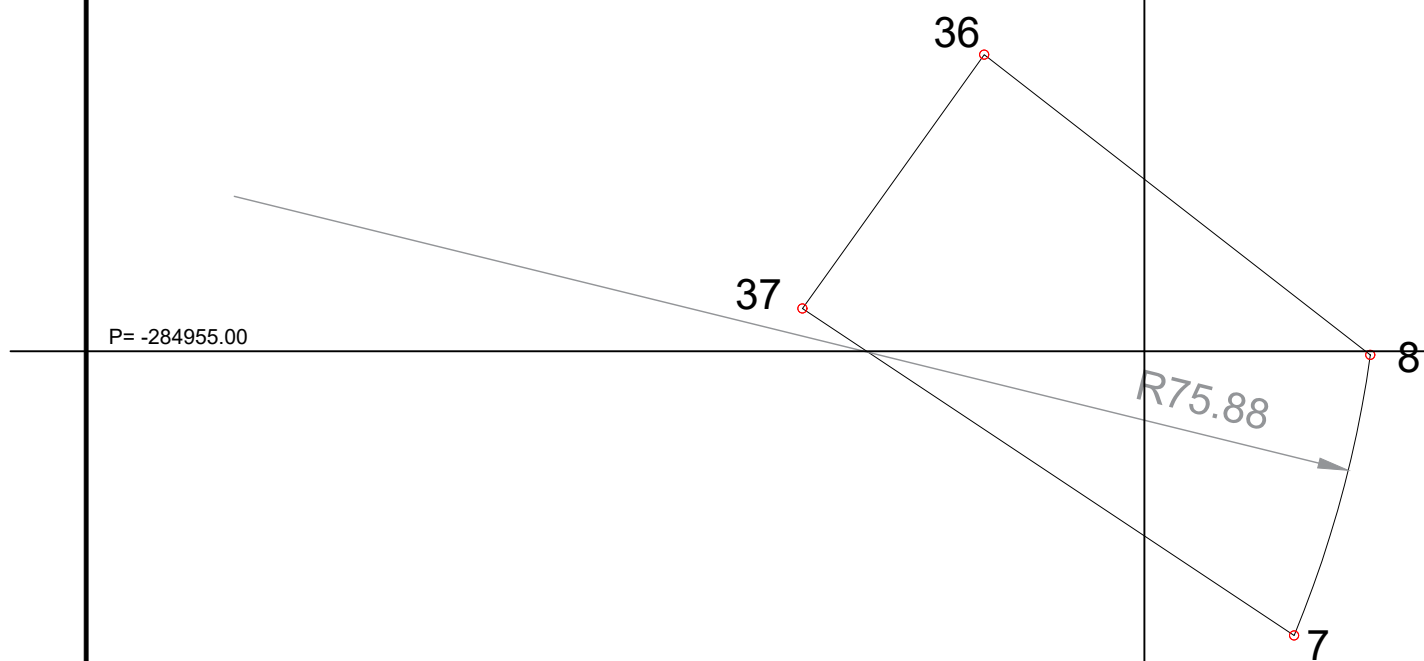

M= 1120.00

Escala = 1:500

# Vilamoura

## ALGARVE

LUSOTUR - Empreendimentos Imobiliários e Turísticos, S.A.

### PLANTA TOPOGRÁFICA

SETOR 4 ZONA 4

SUBZONA 1A LOTE 15

AREA 698 m2

#### ORTOFOTOMAPA

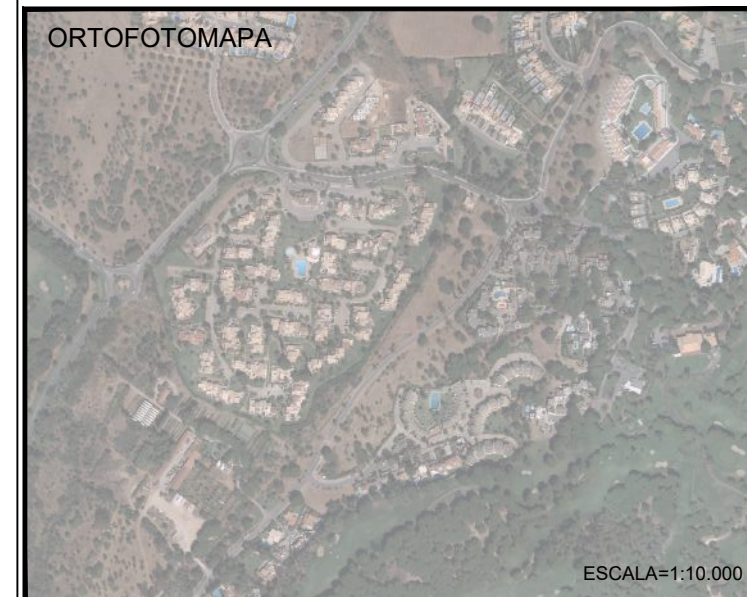

ESCALA=1:10.000

#### PLANTA DE LOCALIZAÇÃO

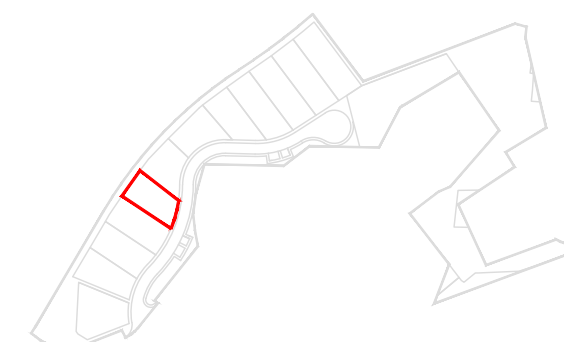

Escala = 1:5000

Lote 4.4.1A/16				
VERTICE	LADO	DIST.	M	P
34	34 - 10	18.57	1128.14	-284914.17
10	10 - 9	19.04	1141.56	-284927.00
9	9 - 8	10.51	1135.69	-284944.77
8	8 - 36	32.36	1134.96	-284955.24
36	36 - 35	9.34	1109.41	-284935.38
35	35 - 34	19.00	1114.96	-284927.86

Lote	Áreas (m <sup>2</sup> )			
	lote	construção	implantação	impermeb.
4.4.1A/16	658	245	200	320

P= -284930.00

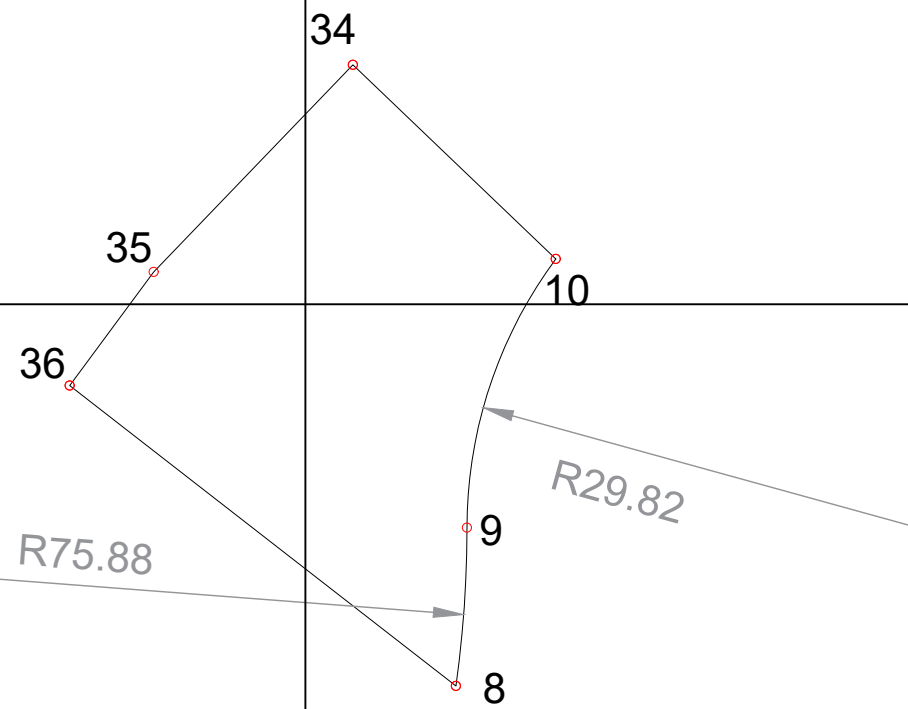

M= 1125

Escala = 1:500

# Vilamoura

## ALGARVE

LUSOTUR - Empreendimentos Imobiliários e Turísticos, S.A.

### PLANTA TOPOGRÁFICA

SETOR 4 ZONA 4

SUBZONA 1A LOTE 16

AREA 658 m<sup>2</sup>

### ORTOFOTOMAPA



ESCALA=1:10.000

### PLANTA DE LOCALIZAÇÃO

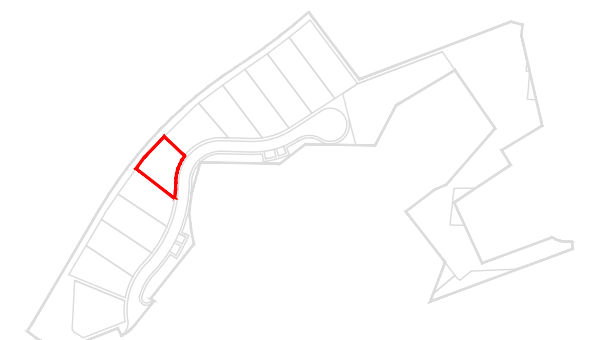

Escala = 1:5000

Lote 4.4.1A/17				
VERTICE	LADO	DIST.	M	P
34	34 - 33	28.69	1128.14	-284914.17
33	33 - 32	2.96	1148.51	-284893.96
32	32 - 12	30.38	1150.77	-284892.06
12	11 - 12	4.35	1170.59	-284915.08
11	11 - 10	28.54	1166.25	-284914.97
10	10 - 34	18.57	1141.56	-284927.00

Lote	Áreas (m <sup>2</sup> )			
	lote	construção	implantação	impermeb.
4.4.1A/17	660	245	200	320

P= -284910.00

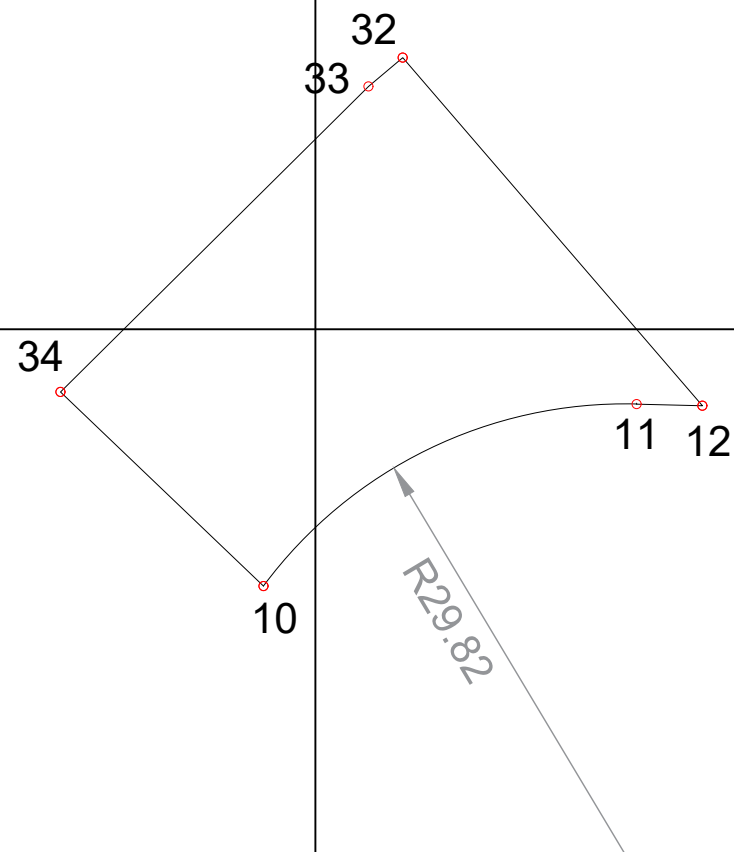

M= 1145

Escala = 1:500

# Vilamoura

## ALGARVE

LUSOTUR - Empreendimentos Imobiliários e Turísticos, S.A.

### PLANTA TOPOGRÁFICA

SETOR 4 ZONA 4

SUBZONA 1A LOTE 17

AREA 660 m<sup>2</sup>

### ORTOFOTOMAPA



ESCALA=1:10.000

### PLANTA DE LOCALIZAÇÃO

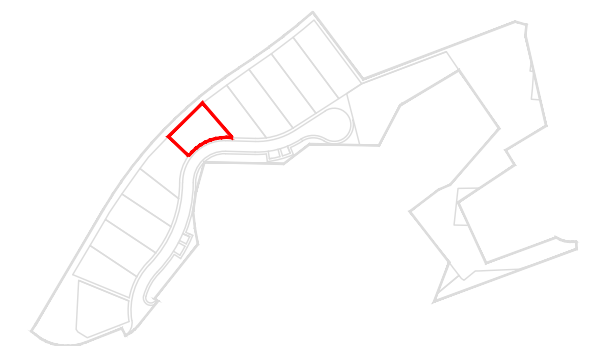

Escala = 1:5000

Lote 4.4.1A/18				
VERTICE	LADO	DIST.	M	P
31	31 - 14	43.61	1166.78	-284880.16
14	14 - 13	7.14	1192.93	-284915.06
13	13 - 12	15.22	1185.81	-284915.46
12	12 - 32	30.38	1170.59	-284915.08
32	32 - 31	19.94	1150.77	-284892.06

Lote	Áreas (m <sup>2</sup> )			
	lote	construção	implantação	impermeb.
4.4.1A/18	697	245	200	320

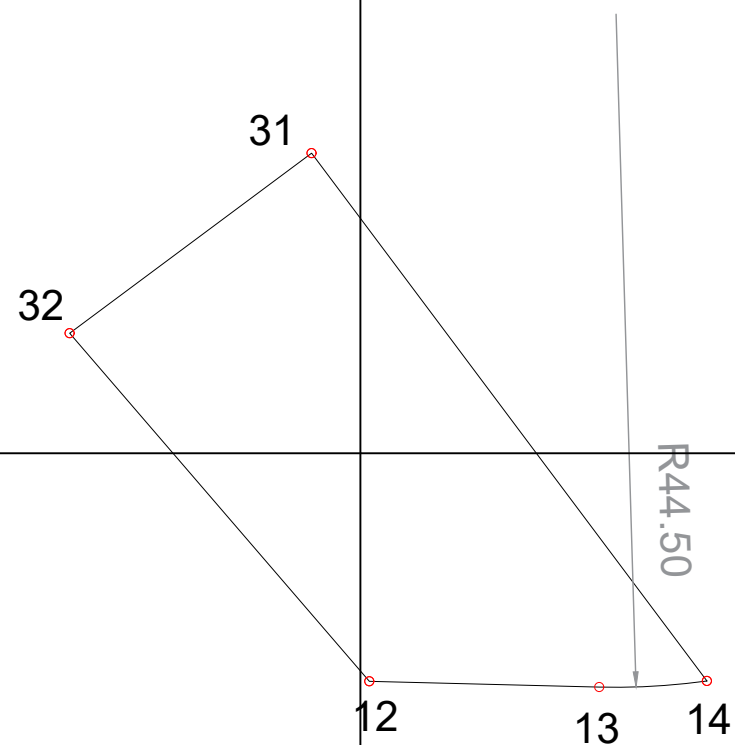

P= -284900.00

M= 1170

Escala = 1:500

# Vilamoura

## ALGARVE

LUSOTUR - Empreendimentos Imobiliários e Turísticos, S.A.

### PLANTA TOPOGRÁFICA

SETOR 4 ZONA 4

SUBZONA 1A LOTE 18

AREA 697 m<sup>2</sup>

### ORTOFOTOMAPA



ESCALA=1:10.000

### PLANTA DE LOCALIZAÇÃO

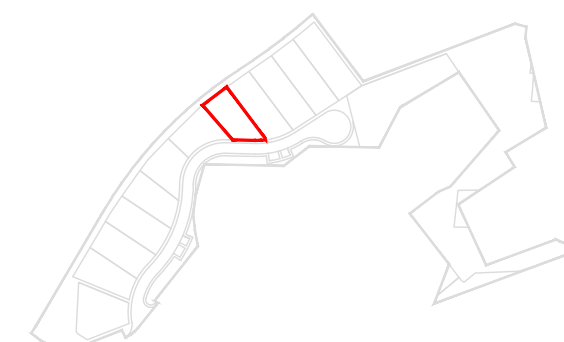

Escala = 1:5000

Lote 4.4.1A/19				
VERTICE	LADO	DIST.	M	P
30	30 - 15	48.58	1181.48	-284869.76
15	15 - 14	18.95	1210.61	-284908.64
14	14 - 31	43.61	1192.93	-284915.06
31	31 - 30	18.01	1166.78	-284880.16

Lote	Áreas (m <sup>2</sup> )			
	lote	construção	implantação	impermeb.
4.4.1A/19	842	265	210	340

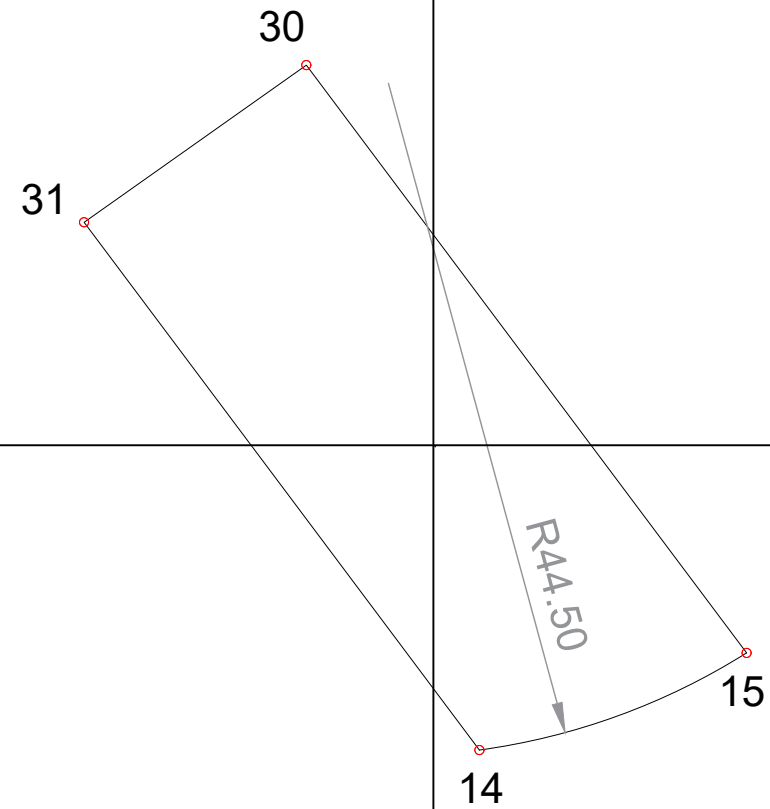

M= 1190

Escala = 1:500

# Vilamoura

## ALGARVE

LUSOTUR - Empreendimentos Imobiliários e Turísticos, S.A.

### PLANTA TOPOGRÁFICA

SETOR 4 ZONA 4  
 SUBZONA 1A LOTE 19  
 AREA 842 m<sup>2</sup>

### ORTOFOTOMAPA



ESCALA=1:10.000

### PLANTA DE LOCALIZAÇÃO

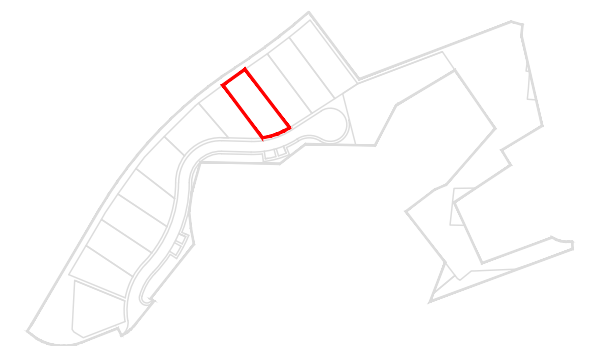

Escala = 1:5000



Lote 4.4.1A/20				
VERTICE	LADO	DIST.	M	P
30	30 - 15	48.58	1181.48	-284869.76
15	15 - 16	0.48	1210.61	-284908.64
16	16 - 17	17.57	1211.01	-284908.38
17	17 - 29	49.23	1225.78	-284898.87
29	29 - 30	18.01	1196.26	-284859.47

Lote	Áreas (m²)			
	lote	construção	implantação	impermeb.
4.4.1A/20	880	265	210	340

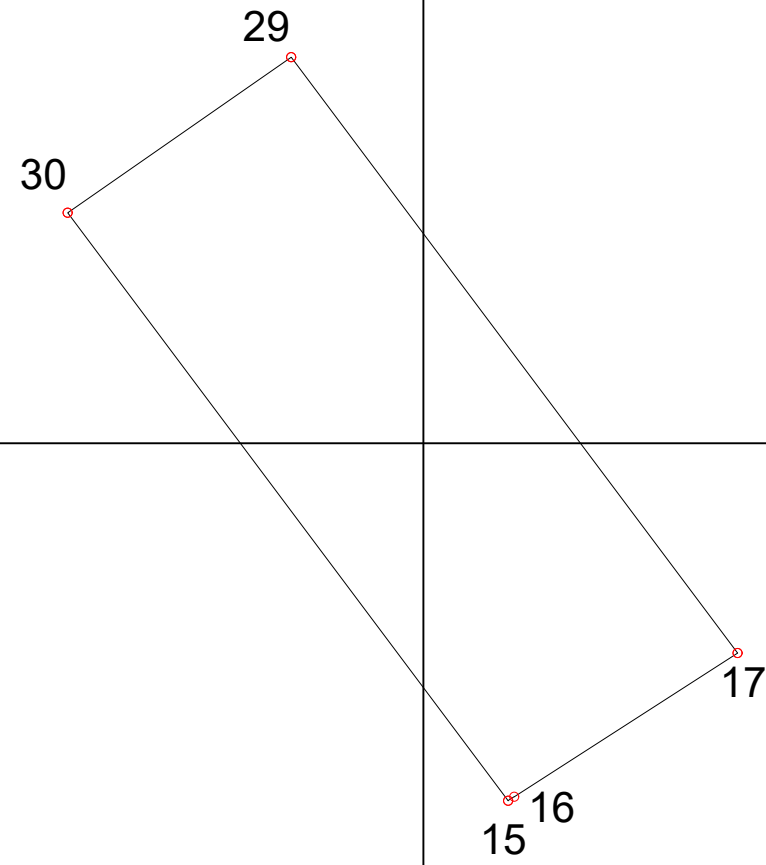

M= 1205

Escala = 1:500

# Vilamoura

## ALGARVE

LUSOTUR - Empreendimentos Imobiliários e Turísticos, S.A.

### PLANTA TOPOGRÁFICA

SETOR 4 ZONA 4  
 SUBZONA 1A LOTE 20  
 AREA 880 m2

### ORTOFOTOMAPA



ESCALA=1:10.000

### PLANTA DE LOCALIZAÇÃO

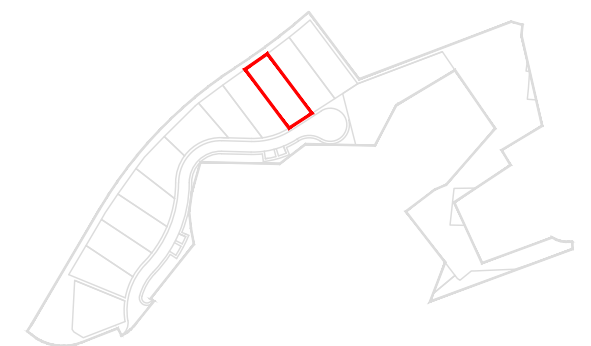

Escala = 1:5000

Lote 4.4.1A/21				
VERTICE	LADO	DIST.	M	P
17	17 - 18	18.05	1225.78	-284898.87
18	18 - 28	50.59	1240.95	-284889.10
28	28 - 29	18.00	1210.62	-284848.61
29	29 - 17	49.23	1196.26	-284859.47

Lote	Áreas (m²)			
	lote	construção	implantação	impermeb.
4.4.1A/21	898	280	230	350

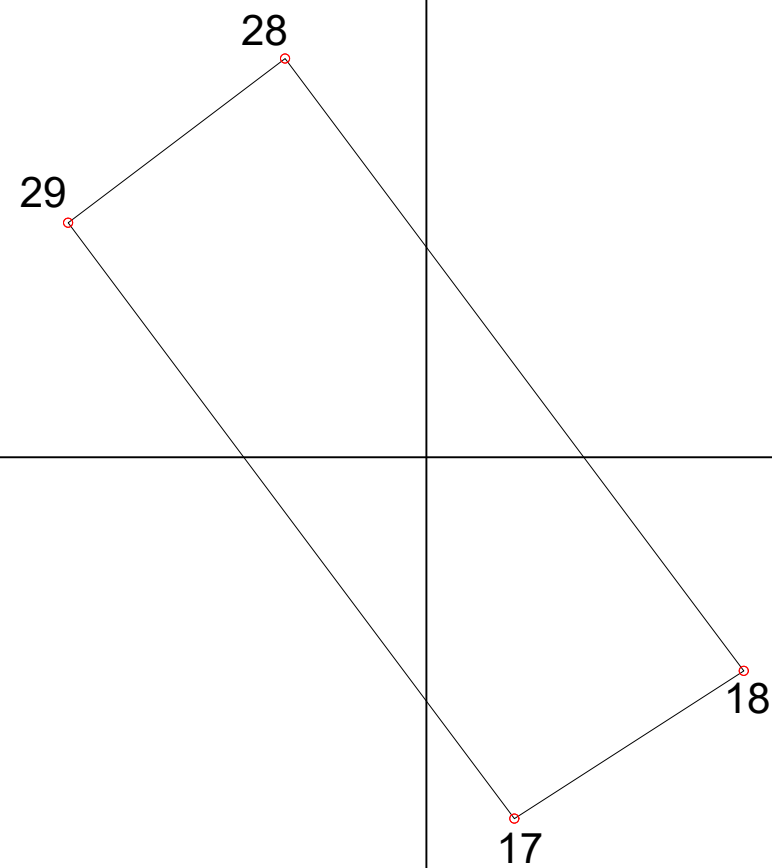

M= 1220

Escala = 1:500

# Vilamoura

## ALGARVE

LUSOTUR - Empreendimentos Imobiliários e Turísticos, S.A.

### PLANTA TOPOGRÁFICA

SETOR 4 ZONA 4

SUBZONA 1A LOTE 21

AREA 898 m2

### ORTOFOTOMAPA



ESCALA=1:10.000

### PLANTA DE LOCALIZAÇÃO

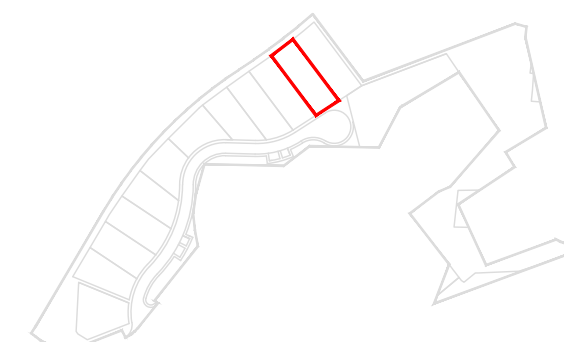

Escala = 1:5000

# Vilamoura

## ALGARVE

LUSOTUR - Empreendimentos Imobiliários e Turísticos, S.A.

### PLANTA TOPOGRÁFICA

SETOR 4 ZONA 4  
 SUBZONA 1A LOTE 22  
 AREA 927 m<sup>2</sup>

Lote 4.4.1A/22				
VERTICE	LADO	DIST.	M	P
18	18 - 26	18.02	1240.95	-284889.10
26	26 - 27	52.68	1256.07	-284879.29
27	27 - 28	18.00	1224.48	-284837.13
28	28 - 18	50.59	1210.62	-284848.61

Lote	Áreas (m <sup>2</sup> )			
	lote	construção	implantação	impermeb.
4.4.1A/22	927	280	230	350

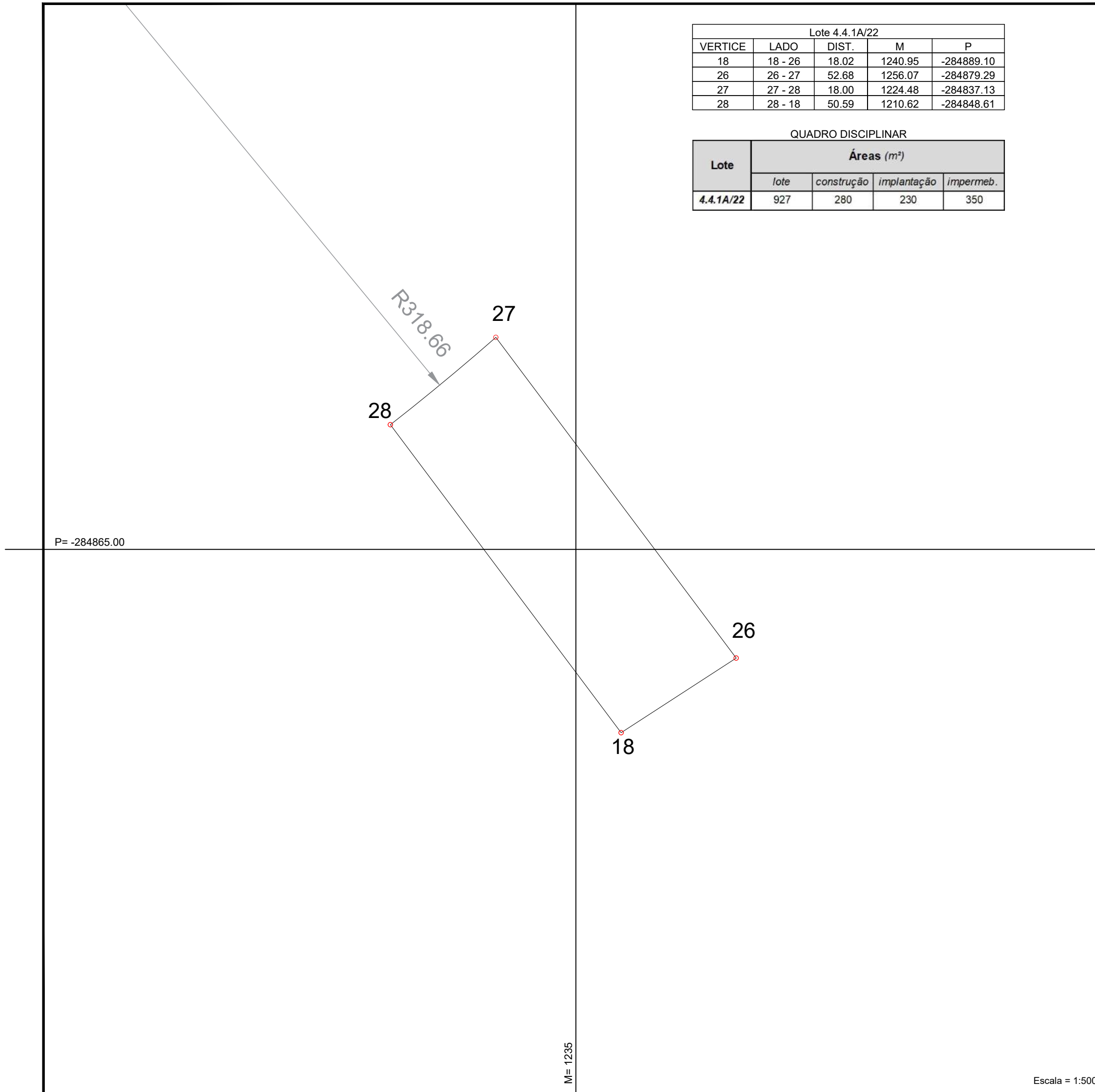

ORTOFOTOMAPA



PLANTA DE LOCALIZAÇÃO

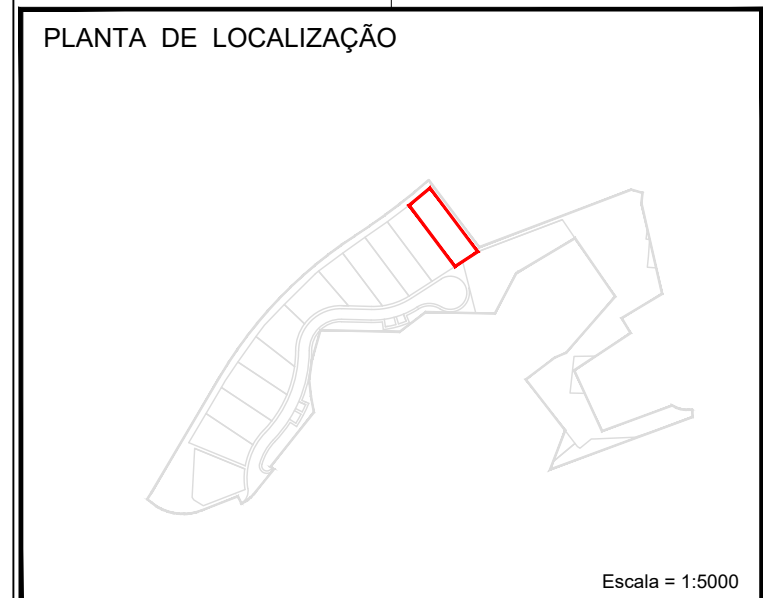

Lote 4.4.1A/23				
VERTICE	LADO	DIST.	M	P
23	23 - 24	43.88	1282.67	-284892.76
24	24 - 25	14.79	1320.40	-284870.34
25	25 - 26	59.84	1312.05	-284858.14
26	26 - 19	11.93	1256.07	-284879.29
19	19 - 20	35.18	1246.06	-284885.78
20	20 - 21	12.62	1254.77	-284919.87
21	21 - 22	30.29	1267.39	-284920.14
22	22 - 23	1.24	1281.61	-284893.39

Lote	Áreas (m <sup>2</sup> )			
	lote	construção	implantação	impermeb.
4.4.1A/23	1 895	305	250	400

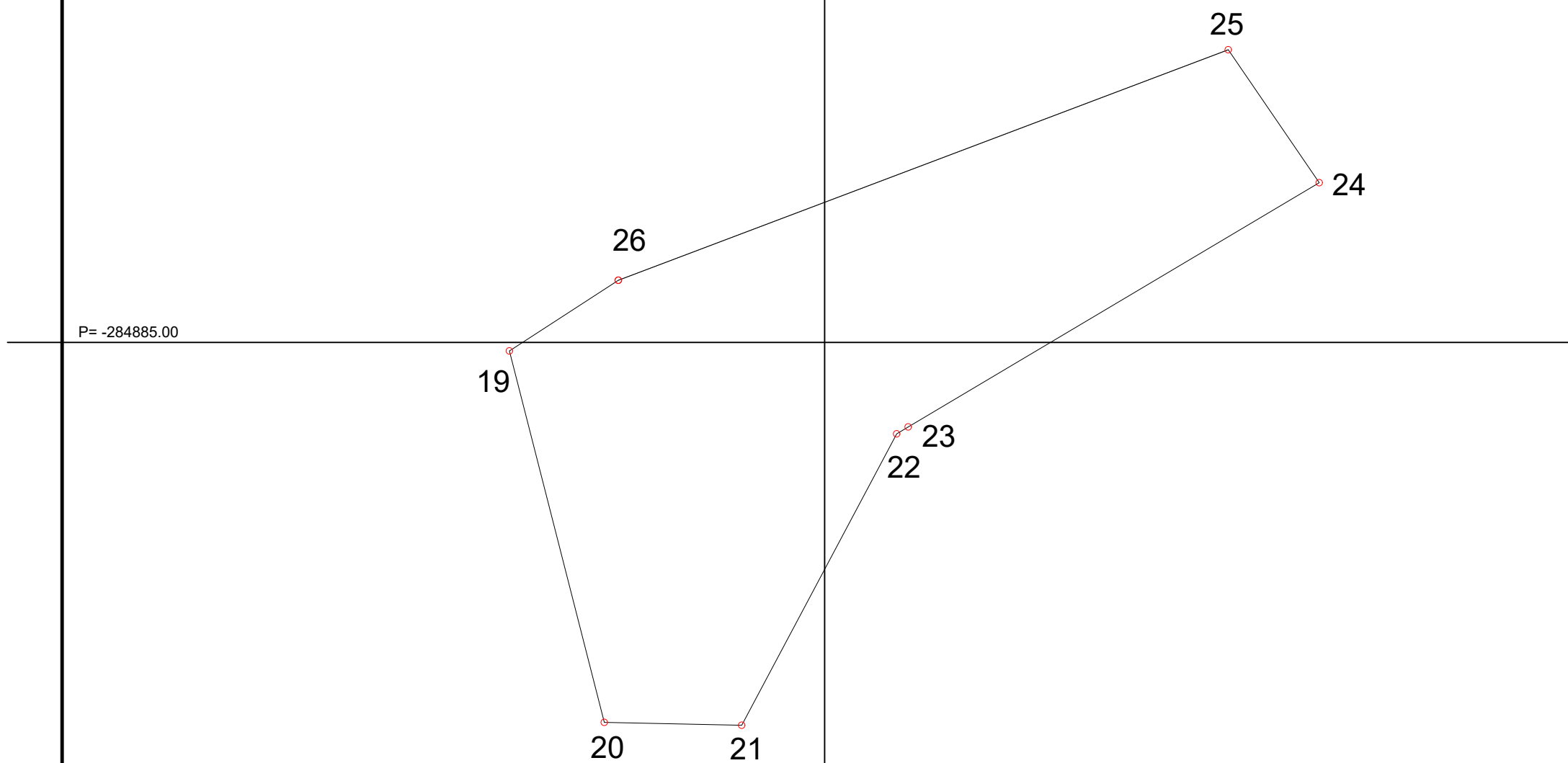

M= 1275

Escala = 1:500

# Vilamoura

## ALGARVE

LUSOTUR - Empreendimentos Imobiliários e Turísticos, S.A.

### PLANTA TOPOGRÁFICA

SETOR 4 ZONA 4  
 SUBZONA 1A LOTE 23  
 AREA 1895 m<sup>2</sup>

ORTOFOTOMAPA



ESCALA=1:10.000

PLANTA DE LOCALIZAÇÃO

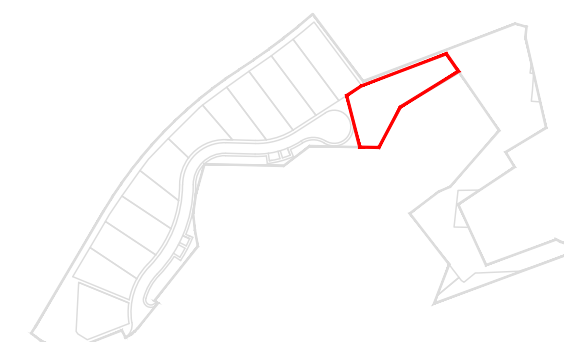

Escala = 1:5000

Lote 4.4.1A/11				
VERTICE	LADO	DIST.	M	P
1	1 - 2	13.65	1102.22	-285036.50
2	2 - 42	35.81	1102.03	-285022.90
42	42 - 43	32.41	1068.88	-285009.34
43	43 - 44	2.07	1067.20	-285041.71
44	44 - 45	7.22	1068.38	-285043.41
45	45 - 1	29.67	1074.54	-285047.18

Lote	Áreas (m <sup>2</sup> )			
	lote	construção	implantação	impermeb.
4.4.1A/11	900	280	230	350

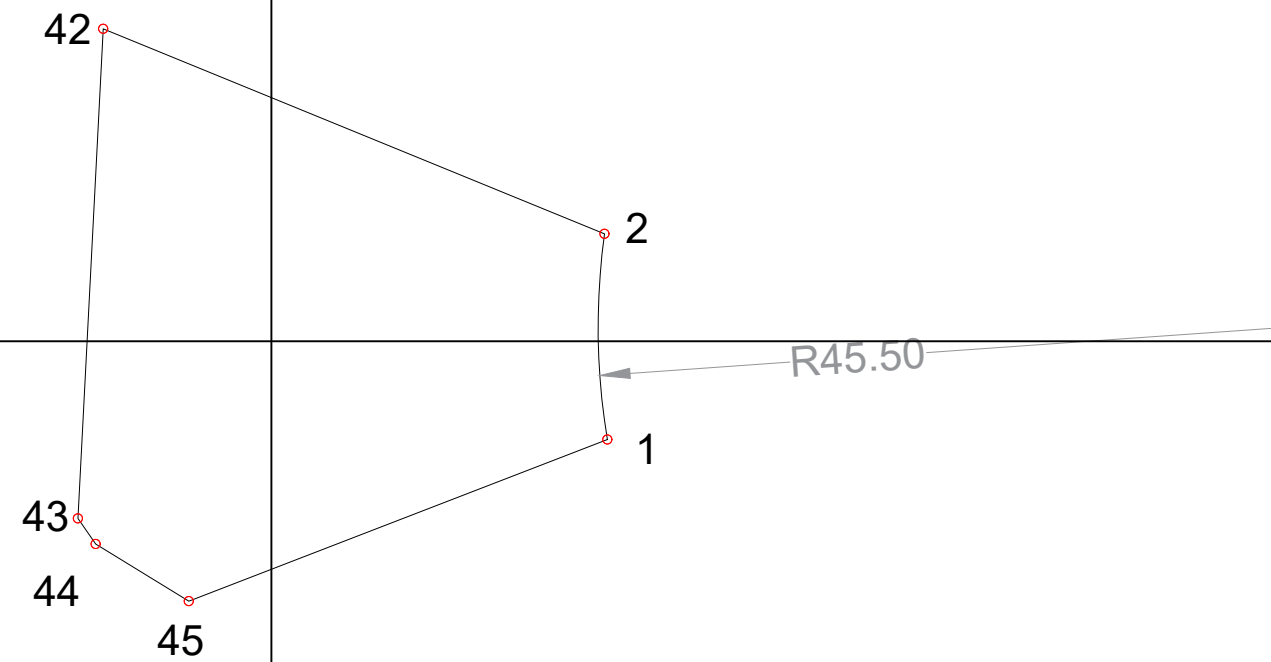

P= -285030

M= 1080

Escala = 1:500

# Vilamoura

## ALGARVE

LUSOTUR - Empreendimentos Imobiliários e Turísticos, S.A.

### PLANTA TOPOGRÁFICA

SETOR 4 ZONA 4

SUBZONA 1A LOTE 11

AREA 900 m<sup>2</sup>

#### ORTOFOTOMAPA



ESCALA=1:10.000

#### PLANTA DE LOCALIZAÇÃO

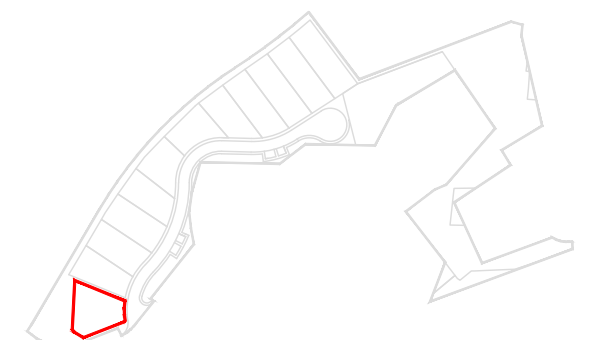

Escala = 1:5000